

**SITE PLAN**  
SUB DIVISION OF PLOT No C-229  
AS C-229-A & C-229-B  
SCALE 1"=16'-0" (1:200)

**NOTE**  
THE 10'-0" (3.0M) WIDE PASSAGE IS ACCESS FOR PLOT No C-229-B ONLY

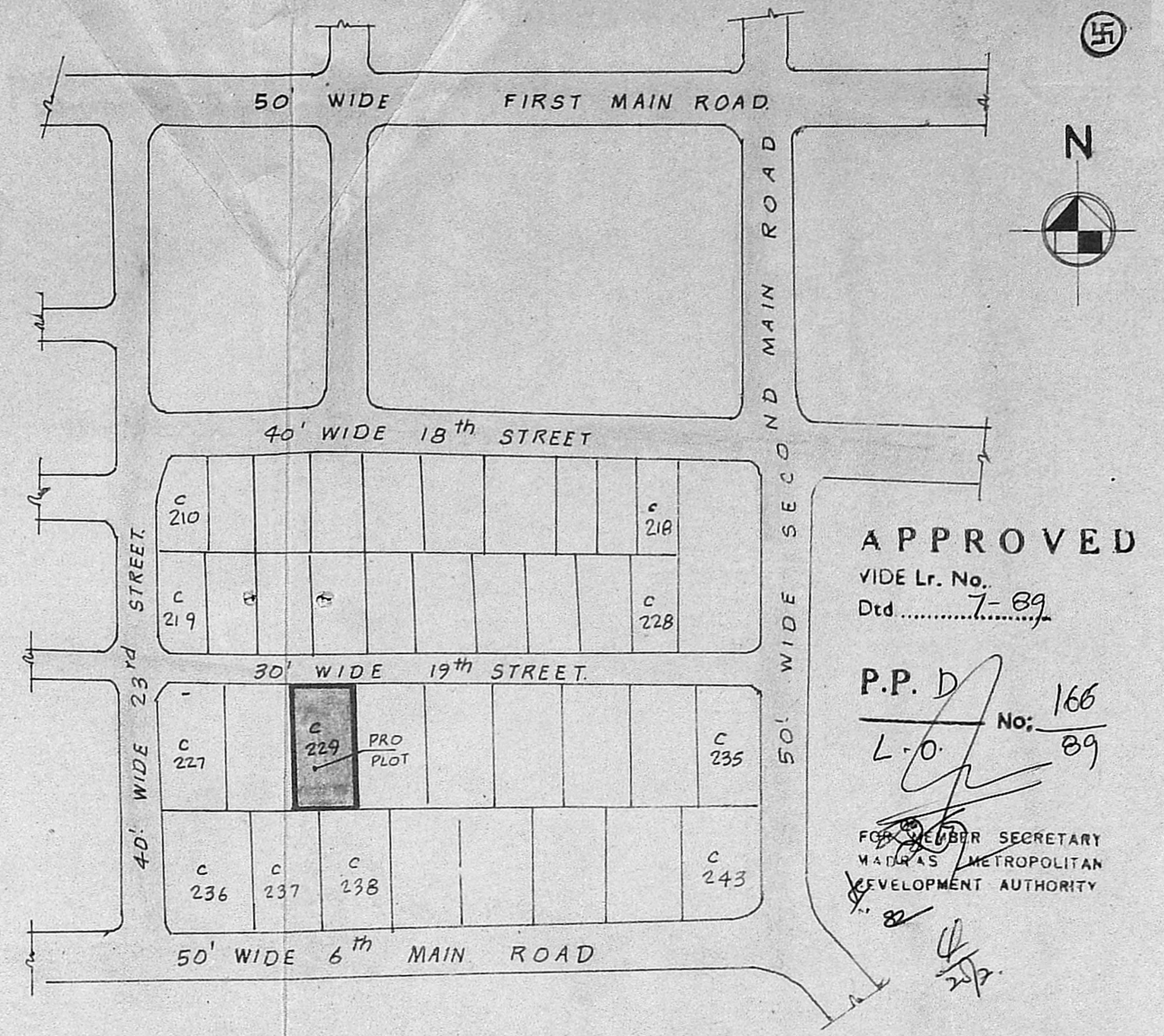

**APPROVED**  
VIDE Lr. No. ....  
Dtd ..... 7-89  
**P.P. D** No: 166  
L.O. No: 89  
FOR MEMBER SECRETARY  
MADRAS METROPOLITAN  
DEVELOPMENT AUTHORITY

REFERENCE				
PLOT No	AREA IN SFT	AREA IN M <sup>2</sup>	COLOUR	REMARKS.
C - 129	6156	571.91		EXISTING PLOT
C - 129-A	3597	334.17		
C - 129-B	1741.5	161.78		
PASSAGE	817.5	75.96		
ROADS	-	-		

PLAN SHOWING THE PROPOSED SUB DIVISION OF PLOT No C-229 AS C-229-A & C-229-B AT 19<sup>th</sup> STREET (Nanganallur) SURVEY Nos 96/1B & 96/2 135, ULLAGARAM VILLAGE SAIDAPET TALUK, CHINGLEPUT DISTRICT.

9 *S. Kripa* (S. KRIPANIDHI)  
Executive Engineer,  
Madras Metropolitan Water Supply  
And Sewerage Board  
Madras-600 008

*S. Sridharan*  
**S. SRIDHARAN, D.C.E.,**  
Licensed Surveyor  
Alandur Municipality  
Res. 81, Ellamuthamman Kovil Street  
(Near Rly Stn.) Palavanthangal  
MADRAS-600114

OWNER **S. Loganathan** LICENSED SURVEYOR